

OKLAHOMA DEPARTMENT OF TRANSPORTATION					
FED. ROAD DIST. NO.	STATE	JOB/PIECE NO.	FISCAL YEAR	SHEET NO.	TOTAL SHEETS
6	OKLA.				
DESCRIPTION		REVISIONS		DATE	

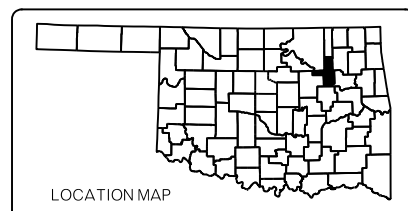

STATE OF OKLAHOMA
DEPARTMENT OF TRANSPORTATION

PLAN OF PROPOSED
UNITED STATES HIGHWAY

STATE AID PROJECT NO. SAP-272N(234)
BRIDGE REPAIR PROJECT
U.S. HIGHWAY 64 UNDER 65TH W AVE.

TULSA COUNTY

CONTROL SECTION NO.: 64-72-86
STATE JOB NO. 33285(04)
BRIDGE "A" LOCATION NO. 7286-1127X
NBI NO. 18564

INDEX OF SHEETS

SHEET NUMBER	SHEET DESCRIPTION
0001	TITLE SHEET
A801	GENERAL NOTES AND SUMMARY OF PAY QUANTITIES (BRIDGE)
AT01	GENERAL NOTES AND SUMMARY OF PAY QUANTITIES (TRAFFIC)
B001	GENERAL PLAN AND ELEVATION
B002	DECK REPAIR DETAIL (SHEET 1 OF 2)
B003	DECK REPAIR DETAIL (SHEET 2 OF 2)
B004	BEAM AND DIAPHRAGM REPAIR DETAILS
B005	TRUSS ASSEMBLY (SHEET 1 OF 2)
B006	TRUSS ASSEMBLY (SHEET 2 OF 2)
T001	TRAFFIC CONTROL DETAIL EASTBOUND OUTSIDE LANE CLOSURE
T002	TRAFFIC CONTROL DETAIL EASTBOUND INSIDE 2 LANES CLOSURE
T003	TRAFFIC CONTROL DETAIL 65TH W AVE BRIDGE

TRAFFIC DESIGN

PROJECT ENGINEER: JAMI SHORT, PE
SQUAD SUPERVISOR: STEVEN WILLIAMS

BRIDGE DESIGN

ENGINEERING MANAGER: MOHAMED ELYAZGI, PE
ENGINEER: MIKE CAO, PE
ENGINEER: KATIE BROWN, PE
SQUAD SUPERVISOR: KEVEN MAYFIELD
SQUAD MEMBERS: REBECCA ADKINSON, JIMMY LONGSDALE
DONNA GOFORTH, ROBERT WEINERT, ALEX GATLEY, NICK WILSON

STANDARDS TO BE INCLUDED FOR THIS PROJECT:

TRAFFIC		BRIDGE
TCS1-1-01	TCS-10-1-00	EJ-SK-04E
TCS2-1-00	TCS11-1-01	EJ-DTL-02E
TCS3-1-01	TCS14-1-00	PTR-2-20 (OBSOLETE)
TCS4-1-01	TCS17-1-00	
TCS5-1-00	TCS18-1-01	
TCS6-1-02	TCS19-1-01	
TCS7-1-02	TCS20-1-00	
TCS8-1-00	TCS21-1-02	
TCS9-1-01		

TULSA COUNTY
BRIDGE "A" LOCATION NO. 7286-1127X
NBI # 18564
LOCATION: 11.2 MI. S-E OSAGE CO
CONTROL SECTION NO: 64-72-86
TOWNSHIP T19N - RANGE R11E / R12E
FACILITY CARRIED: 65TH W. AVE
FACILITY INTERSECTED: US-64

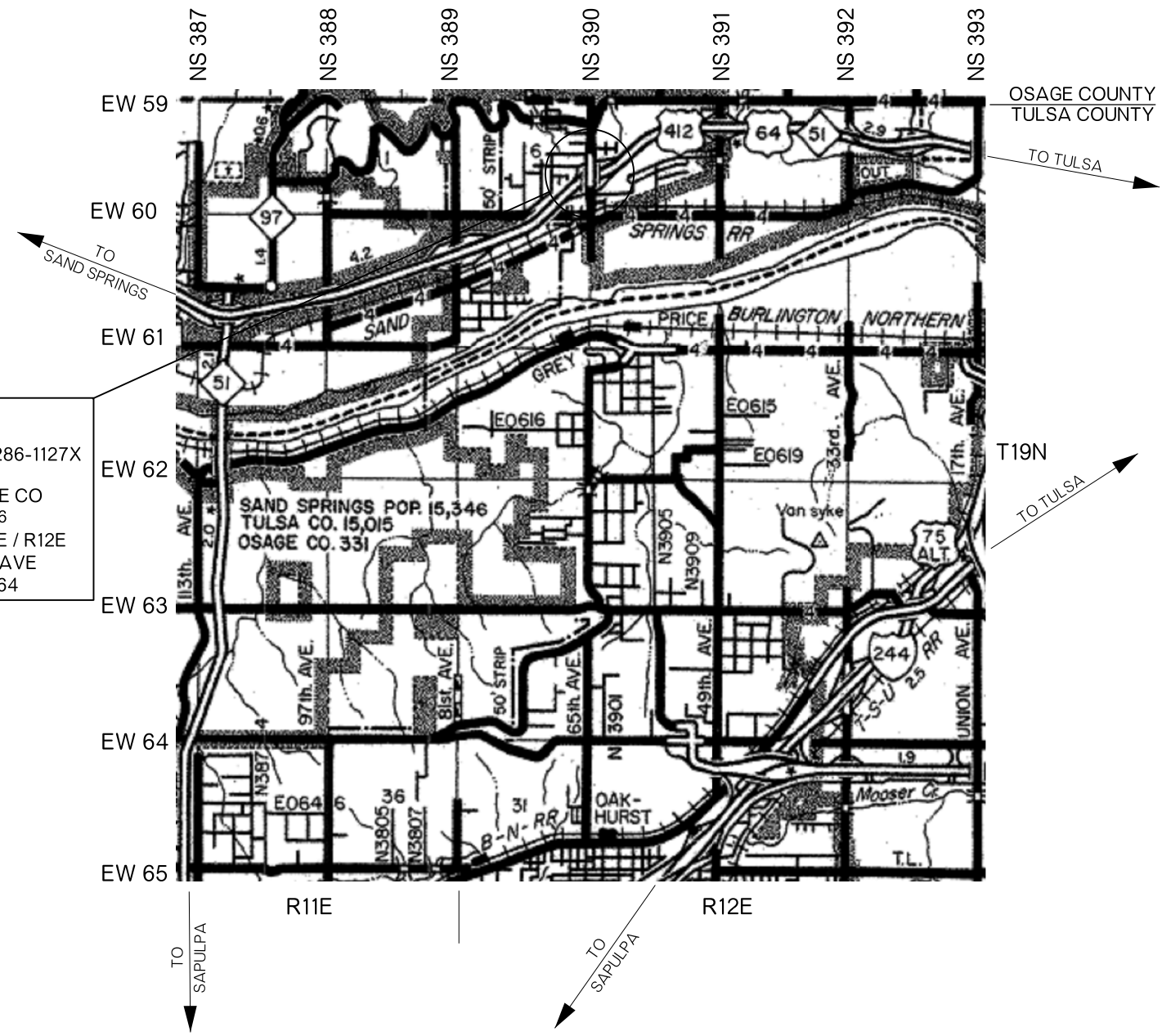

CONVENTIONAL SYMBOLS

- PROPOSED ROAD
- RAILROADS
- RANGE & TOWNSHIP SECTION LINES
- QUARTER SECTION LINES
- FENCES
- GROUND LINE
- EXISTING ROADS
- BASE LINE
- GRADE LINES
- TELEPHONE & TELEGRAPH
- POWER LINES
- BUILDINGS
- OILWELL
- DRAINAGE STRUCTURES - IN PLACE
- DRAINAGE STRUCTURES - NEW
- RIGHT-OF-WAY LINES - EXISTING
- RIGHT-OF-WAY LINES - NEW
- CONTROLLED ACCESS
- RIGHT-OF-WAY FENCE

2009 OKLAHOMA STANDARD SPECIFICATIONS FOR HIGHWAY CONSTRUCTION GOVERN, APPROVED BY THE U.S. DEPARTMENT OF TRANSPORTATION, FEDERAL HIGHWAY ADMINISTRATION, JANUARY 4, 2010.

OKLAHOMA DEPARTMENT OF TRANSPORTATION
BRIDGE DESIGN DIVISION
M. ELYAZGI, P.E.
OKLA. REG. NO. 17542
DATE: 08/11/2017

OKLAHOMA DEPARTMENT OF TRANSPORTATION DATE APPROVED: _____ BY: _____ CHIEF ENGINEER	DEPARTMENT OF TRANSPORTATION FEDERAL HIGHWAY ADMINISTRATION DATE APPROVED: _____ BY: _____ DIVISION ADMINISTRATOR
SWO _____	PROJECT NO. SAP-272N(234)
COUNTY TULSA	HIGHWAY US-64 SHEET NO. 0001

P.E. NO. 33285(01)